



CSA AIR CREW TRAINING

CATALOGUE

2011





Readers' note

For better understanding please find explanation of the course code as follow:

F - Flight Crew
C - Cabin Crew
TR - Type Rating
MCC - Muliti-crew Cooperation Course
TRI - Type Rating Instructor
ZFTT - Zero Flight Time Training
CC - Conversion Course
CRM - Crew Resource Management
DG - Dangerous Goods
SEC - Security
I - Initial
G - General
ATR - ATR 42/72
737 - B737 300/400/500
320 - A319/320/321

Example:

F 320 TR
↓ ↓ ↓
↓ ↓ Type Rating Course
↓ A320
Flight Crew

F C DG I
↓ ↓ ↓ ↓
↓ ↓ Initial Course
↓ Dangerous Goods
Cabin Crew
Flight Crew

EU- OPS - Commission Regulation (EC) No 859/2008



Table of Contents

Flight Crew Courses	5
F 320TR	A320 Type Rating Course..... 6
F 320SFI	A320 Synthetic Flight Instructor Course..... 7
F 320TRI	A320 Type Rating Instructor Course..... 8
F ATRTR	ATR 72-202/42-500 Type Rating Course..... 9
F ATRTR3	ATR 72-202/42-500,320 Type Rating Course.....10
F ATR MCCA	MCC Attached Course.....11
F ATRMCCB	MCC Basic Course.....12
F ATRTRI	ATR Type Rating Instructor Course.....13
F 737TR	B 737 Type Rating Course.....14
F737 MCCA	Multi Crew Co-Operation Attached Course.....15
F 737MCCB	Multi Crew Co-Operation Basic Course.....16
F 737TRI	B737 Type Rating Instructor.....17
F 737SFI	B737 Synthetic Flight Instructor.....18
F ABT	Air Base Training for A320,B737, ATR.....19
F TCAS	Traffic Collision Avoidance System.....20
F CFIT	Control Flight Into Terrain.....21
F RVSM	Reduced Vertical Separation Minima.....22
F CRMI	Crew Resource Management Initial Course.....23
F CRMR	Crew Resource Management Recurrent.....24
F DGI	Dangerous Goods Initial Course.....25
F DGR	Dangerous Goods Recurrent Course.....26
F SECI	Security Initial Course.....27
F SECR	Security Recurrent Course.....28
FC WST	Water Survival Training Course.....29
F FFST	Fire Fighting and Smoke Training.....30
F FF LT	Fire Fighting and Lifejacket Training.....31
Cabin Crew Courses	33
C ICC	Cabin Crew Initial Safety Training.....34
C ATRCC	Conversion Course ATR 42/72.....35
C 737CC	Conversion Course for B737- 400/500.....36
C 320CC	Conversion Course for A 319/320/321.....37
C SECI	Security Initial Training.....38
C SECR	Security Recurrent Training.....39
C ESE	Emergency and Safety Procedures Training.....40
C INSC	Cabin Crew Instructor Course.....41
C RT	Refresher Training Course.....42

C CRMI	Crew Resource Management Initial Course	43
C CRMR	Crew Resource Management Recurrent	44
C DGI	Dangerous Goods Initial Course	45
C DGR	Dangerous Goods Recurrent Course	46
C CRMIN	Crew Resource Management Instructor Course	47
C FFST	Fire Fighting and Smoke Training Course	48
C MEDI	Medical Aspects and First Aid Training	49
C MED R	First Aid Recurrent Training	50
FC ESE G	Emergency and Safety Procedures Training	51
CSA Air Crew Training	52
Training facilities and equipment.....	52
Flight Simulators and flight training devices	53
Other activities.....	59
Simulator Flying “ Funny Flying”.....	60
Excursions.....	62
General Terms and Conditions	64
Accommodation options at Prague destination	66
Contacts and map	68

Flight Crew Courses

Prerequisites

A valid CPL(A) or ATPL(A) with a valid Class 1 Medical Certificate

A valid ATPL Theoretical Knowledge Credit

At least 100 hours as a pilot-in-command (PIC) of aeroplanes

A valid Multi-engine Instrument Rating (A)

To hold a certificate of satisfactory completion of a Multi-crew Co-operation course (MCC)

Course Duration

25 days (excluding LVO)

Course Location

Prague, Czech Republic (Air Crew Training)

Language

English, Czech

Description

The aim of the Type Rating Course of the A320 is to train aeroplane licence holders to the level of proficiency necessary for the issue of the A320 Type Rating.

The A320 Type Rating Course fulfils the requirements of JAR-FCL 1.240 & 1.261

Ground Training**53 hrs (5 days)**

Classroom Training

15,5 hrs

Airbus Philosophy, Airbus CRM, FCOM, LPC..

8,5 hrs

Performance

7 hrs

Computer Based Training (CBT) - class room study

13 hrs

MFTD Familiarization - 2x1 hr

2 hrs

Cabin Trainer (Emergency Procedures)

1 hr

Tests (Performance and Systems)

6 hrs

Simulator Training

MFTD (Maintenance Flight Training Device)

78 hrs (10 days)

10 sessions, 4 hrs each

40 hrs

20 hrs right seat, 20 hrs left seat

CBT self study before each MFTD session

38 hrs

Full Flight Simulator Training - 8 sessions, 4hrs each

32 hrs (8 days)

16 hrs right seat, 16 hrs left seat

2 hrs briefing and 1 hr debriefing

Skill Test - 1 session

4 hrs (1 day)

Aircraft Training - 6 take-offs and landings**1hr 15' (1day)**

2 hrs briefing and 1 hr debriefing

or

Full Flight Simulator (in case ZFTT)**1 hr****Documentation**

A 320 documentation may be lent to all participants at the beginning of the training

Prerequisites

To hold or have held a professional pilot licence issued by a JAA Member State or a non JAR-FCL licence acceptable to the Authority

To have completed the simulator content of the applicable type rating course at an approved FTO or TRTO

To have at least 1500 hours flying experience as a pilot on multi-pilot aeroplanes

To have completed, within a period of 12 months preceding the application, a proficiency check on a flight simulator A320

To have completed, within a period of 12 months preceding the application, at least 3 route sectors as a pilot or an observer on the flight deck of A320

Course Duration

5 days

Course Location

Prague, Czech Republic (Air Crew Training)

Language

English, Czech

Description**Ground Training**

Teaching and Learning	20 hrs (3 days)
-----------------------	-----------------

Simulator Training

FFS USE - Familiarization with FFS	1,5hr (1 day)
------------------------------------	---------------

Supervised Training Phase	4 hrs (1 day)
---------------------------	---------------

Documentation

A320 documentation may be lent to all participants at the beginning of the training

Prerequisites

To hold a valid A320 Type Rating as a pilot-in-command;
To have completed at least 1,500 flight hours as a pilot of multi-pilot aeroplanes;
To have completed, within the 12 months preceding the application, at least 30 route sectors, to include take-offs and landings as a pilot-in-command or co-pilot on the A320, of which not more than 15 sectors may be completed on a flight simulator.

Course Duration

6 days

Course Location

Prague, Czech Republic (Air Crew Training)

Language

English, Czech

Description**Ground Training**

Teaching and Learning 20 hrs (3 days)

Simulator Training

FFS USE - Familiarization with FFS 1.5hr (1 day)

Airborne Phase 3 hrs

Supervised Training Phase 4 hrs (1 day)

Airplane Training

0 hr 45' (1 day)

Documentation

A320 documentation may be lent to all participants at the beginning of the training

F ATRTR ATR 72-202/42-500 Type Rating Course

Prerequisites

Valid CPL(A) or ATPL(A) with a valid Class 1 Medical Certificate
Valid ATPL Theoretical Knowledge Credit
At least 100 hours as a pilot-in-command (PIC) of aeroplanes
Valid Multi-engine Instrument Rating (A)
To hold a certificate of satisfactory completion of a Multi-crew Co-operation course (MCC)

Course Duration

35 days

Course Location

Prague, Czech Republic (Air Crew Training), Thessaloniki or Helsinki

Language

Czech, English

Description

The aim of the ATR 42/72 Type Rating Course is to train aeroplane licence holders to the level of proficiency necessary for the issue of the ATR 42-500 & ATR 72-202 Type Rating.

The ATR 42/72 Type Rating Course fulfils the requirements of JAR-FCL 1.240 & 1.261.

Ground Training (Aircraft systems and Procedures)	141 hrs (21 days)
CBT, Self-study	49 hrs
Cockpit Procedure Trainer	16 hrs
Aircraft familiarisation on the ground	5 hrs
Classroom Training	61 hrs
Tests during theoretical training	6 hrs
Performance, Limitations, Load and balance, Procedures, Area navigation, Diff ATR 42-500	
Final Test	4 hrs
Simulator Training	
Flight Training Devices - 4 sessions 8 hrs right seat, 8 hrs left seat 1 hr briefing and 0,5 hr debriefing for a session	16 hrs (4 days) in PRG
Full Flight Simulator - 5 sessions HEL 9 hrs right seat, 9 hrs left seat 1 hr briefing and 0,5 hr debriefing for a session	18 hrs (5 days) in SKG,
Full Flight Simulator - Skill Test - 2 sessions 1 hr briefing and 0,5 hr debriefing for a session 3 hrs as a non-flying pilot, 3 hrs as a flying pilot	6 hrs (2 days)
(The following items are not included: LVO, MCC, Diff. ATR 42-320)	
Aircraft Training - 6 take-offs and landings	1hr 15' (1day)
1 hr briefing and 0,5 hr debriefing for a session	

Documentation - ATR documentation may be lent to all participants at the beginning of the training

F ATRTR3 Course

ATR 72-202/42-500,320 Type Rating

Prerequisites

Valid CPL(A) or ATPL(A) with a valid Class 1 Medical Certificate
Valid ATPL Theoretical Knowledge Credit
At least 100 hours as a pilot-in-command (PIC) of aeroplanes
Valid Multi-engine Instrument Rating (A)
To hold a certificate of satisfactory completion of a Multi-crew Co-operation course (MCC)

Course Duration

36 days

Course Location

Prague, Czech Republic (Air Crew Training), Thessaloniki or Helsinki
Language
Czech, English

Description

The aim of the ATR 42/72 Type Rating Course is to train aeroplane licence holders to the level of proficiency necessary for the issue of the ATR 72-202, ATR 42-500, 320 Type Rating. The ATR 42/72 Type Rating Course fulfils the requirements of JAR-FCL 1.240 & 1.261.

Ground Training

	149 hrs (22 days)
CBT, Self-study	49 hrs
Cockpit Procedure Trainer	16 hrs
Aircraft familiarisation on the ground	5 hrs
Classroom training (Incl. Diff 42-500, 320)	69 hrs
Tests during theoretical training	6 hrs
Final test	4 hrs

Simulator Training

Flight Training Devices - 4 sessions 8 hrs right seat, 8 hrs left seat 1 hr briefing and 0,5 hr debriefing for a session	16 hrs (4 days) in PRG
Full Flight Simulator - 5 sessions 9 hrs right seat, 9 hrs left seat 1 hr briefing and 0,5 hr debriefing for a session	18 hrs (5 days) in SKG, HEL
Full Flight Simulator - Skill Test - 2 sessions 1 hr briefing and 0,5 hr debriefing for a session 3 hrs as a non-flying pilot, 3 hrs as a flying pilot	6 hrs (2 days)
Full Flight Simulator - Differences ATR42-320 (The following items are not included: LVO, MCC)	2 hrs (1 days)

Aircraft Training - 6 take-offs and landings

1 hr briefing and 0,5 hr debriefing for a session	1hr 15´ (1day)
---	-----------------------

Documentation

ATR documentation may be lent to all participants at the beginning of the training

F ATR MCCA MCC Attached Course

Prerequisites

Valid CPL(A) with a valid Class 1 Medical Certificate
Valid ATPL Theoretical Knowledge Credit
At least 100 hours as a pilot-in-command (PIC) of aeroplanes
Valid Multi-engine Instrument Rating (A)

Course Duration

7 days

Course Location

Prague, Czech Republic (Air Crew Training)

Language

Czech, English

Description

The aim of the Attached MCC course is to become proficient in multi-crew co-operation (MCC) in order to operate multi-pilot multi-engine aeroplanes safely.

MCC Course fulfils the requirements of JAR-FCL 1.261(d).

Ground Training	25 hrs (3 days)
Interfaces	2 hrs
Non-Technical Skills	16 hrs
Check-list Philosophy	2 hrs
Task Division	2 hrs
Mutual Supervision, Information and Support	3 hrs

Simulator Training	10 hrs (3 days)
Fix Base Simulator - 2,5 sessions	
Take – Off	2 hrs
Instrument Flight Procedures	4 hrs
Landing	2 hrs
Stall Recovery Procedures	2 hrs

Documentation

ATR documentation may be lent to all participants at the beginning of the training

F ATRMCCB MCC Basic Course

Prerequisites

Valid CPL(A)

Course Duration

9 days

Course Location

Prague, Czech Republic (Air Crew Training)

Language

Czech, English

Description

The aim of the Basic MCC course is to become proficient in multi-crew co-operation (MCC) in order to operate multi-pilot multi-engine aeroplanes safely.

MCC Course fulfils the requirements of JAR-FCL 1.261(d).

Ground Training

25 hrs (3 days)

Interfaces	2 hrs
Non-Technical Skills	16 hrs
Check-list Philosophy	2 hrs
Task Division	2 hrs
Mutual Supervision, Information and Support	3 hrs

Simulator Training

20 hrs (5 days)

Fix Base Simulator - 5 sessions	
Flight Preparation	2 hrs
Take – Off	2 hrs
Instrument Flight Procedures	4 hrs
Missed Approach Procedures	2 hrs
Landing	2 hrs
Stall Recovery Procedures	2 hrs
Operation of Aircraft Systems	3 hrs
Emergency Procedures	

Documentation

ATR documentation may be lent to all participants at the beginning of the training

Prerequisites

Valid CPL(A) or ATPL(A) with a valid Class 1 Medical Certificate
Valid ATPL Theoretical Knowledge Credit
At least 100 hours as a pilot-in-command (PIC) of aeroplanes
Valid Multi-engine Instrument Rating (A)
To hold a certificate of satisfactory completion of a Multi-crew Co-operation course (MCC)

Course Duration

29 days

Course Location

Prague, Czech Republic (Air Crew Training Centre)

Language

Czech, English

Description

The aim of the Type Rating Course of the B737 is to train aeroplane licence holders to the level of proficiency necessary for the issue of the B737 Type Rating.

The B737 Type Rating Course fulfils the requirements of B737 of JAR-FCL 1.240 & 1.261.

Ground Training (Aircraft systems and procedures) 112 hrs (14 days)

Computer Based Training-self study	55 hrs
Classroom Training	46 hrs
Tests	9 hrs

Simulator Training

Fix Base Simulator - 5 sessions, 4hrs each 10 hrs right seat, 10 hrs left seat 2 hrs briefing and 1 hr debriefing for a session	20 hrs (5 days)
---	-----------------

Full Flight Simulator - 8 sessions, 4hrs each 18 hrs right seat, 18 hrs left seat 2 hrs briefing and 1 hr debriefing for a session	32 hrs (8 days)
--	-----------------

Full Flight Simulator- Skill Test -1 session 2 hrs briefing and 1 hr debriefing 2 hrs as a non-flying pilot, 2 hrs as a flying pilot	4 hrs (1 day)
--	---------------

Aircraft Training - 6 take-offs and landings or	1hr 15' (1day)
---	-----------------------

Full Flight Simulator (in case ZFTT)	1 hr
---	-------------

Documentation

B737 Documentation may be lent to all participants at the beginning of the training.

F737 MCCA Multi Crew Co-Operation Attached Course

Prerequisites

The applicant shall fulfil the entry requirements for the B 737 Type Rating Course as a pilot-in-command or a co-pilot (as applicable)

Course Duration

7 days

Course Location

Prague, Czech Republic (Air Crew Training Centre)

Language

Czech, English

Description

Ground Training

25 hrs (3 days)

Interfaces
Non-Technical Skills
Check-list Philosophy
Task Division
Mutual Supervision, Information and Support

Simulator Training

10 hrs (3 days)

Fix Base Simulator - 2,5 sessions
Take – Off
Instrument Flight Procedures
Landing
Stall Recovery Procedures

Documentation

B737 Documentation may be lent to all participants at the beginning of the training

F 737MCCB Multi Crew Co-Operation Basic Course

Prerequisites

The applicant shall hold or has held a pilot licence

Course Duration

9 days

Course Location

Prague, Czech Republic (Air Crew Training Centre)

Language

Czech, English

Description

Ground Training

25 hrs (3 days)

Interfaces
Non-Technical Skills
Check-list Philosophy
Task Division
Mutual Supervision, Information and Support

Simulator Training

20 hrs (5 days)

Fix Base Simulator - 5 sessions
Flight Preparation
Take – Off
Instrument Flight Procedures
Missed Approach Procedures
Landing
Stall Recovery Procedures
Operation of Aircraft Systems
Emergency Procedures

Documentation

B737 Documentation may be lent to all participants at the beginning of the training

Prerequisites

Valid B737 Type Rating as a pilot-in-command

To have completed at least 1500 flight time hours as a pilot of multi-pilot aeroplanes

To have completed, within the 12 months preceding the application, at least 30 route sectors, to include take-offs and landings as a pilot-in-command or co-pilot on the B737, of which not more than 15 sectors may be completed on a flight simulator

Course Duration

13 days

Course Location

Prague, Czech Republic (Air Crew Training)

Language

Czech, English

Description**Ground Training**

Teaching and Learning

25 hrs (3 days)

25 hrs

Technical Training

Full Flight Simulator

2 hrs (1 day)

Aircraft Training-aeroplane exercises

1 hr (1 day)

Full Flight Simulator (in case ZFTT)

1 hr

2 hours briefing and 1 hour debriefing

STD Familiarization

5 hrs (1 day)

STD Operational Procedures

1 hr

Fix Base Simulator

2 hrs

Full Flight Simulator

2 hrs

Training under Supervision

Full Flight Simulator

3 hrs (1 day)

Aircraft Training

45' (1 day)

4 take-offs and landings

2 hours briefing and 1 hour debriefing

Documentation

B737 Documentation may be lent to all participants at the beginning of the training

Prerequisites

To hold or have held a professional pilot licence issued by a JAA Member State or a non JAR-FCL licence acceptable to the Authority

To have completed the simulator content of the applicable type rating course at an approved FTO or TRTO.

To have at least 1500 hours flying experience as a pilot on multi-pilot aeroplanes

To have completed, within a period of 12 months preceding the application, a proficiency check on a B737 flight simulator

To have completed, within a period of 12 months preceding the application, at least 3 route sectors as a pilot or an observer on the flight deck of B737

Course Duration

8 days

Course Location

Prague, Czech Republic (Air Crew Training)

Language

Czech, English

Description

Teaching and Learning 25 hrs (3 days)

Technical Training

Full Flight Simulator 2 hrs (1day)
2 hrs briefing and 1 hr debriefing

STD Familiarization

Classroom Training 1 hr
Fix Base Simulator 1 session 2 hrs
Full Flight Simulator 1 session 2 hrs

Training under Supervision

Full Flight Simulator 1 sessions 3 hrs (1 day)
2 hrs briefing and 1 hr debriefing

Documentation

B737 Documentation may be lent to all participants at the beginning of the training

Prerequisites

Valid CPL(A) or ATPL(A) with a valid Class 1 Medical Certificate
Valid ATPL Theoretical Knowledge Credit
At least 100 hours as a pilot-in-command (PIC) of aeroplanes
Valid Multi-engine Instrument Rating (A)
To hold a certificate of satisfactory completion of a Multi-crew Co-operation course (MCC)
Completed whole type rating course including Type Rating Examination

Course Duration

1 day

Course Location

Prague airport, Pardubice airport, Brno airport, Vodochody airport, Ostrava airport
(depend on actual weather and RWY condition)

Language

Czech, English

Description

Full Flight Simulator session	From 30' to 2hrs.
Aircraft Training 4 or 6 take-offs and landings	From 40' to 1 hr 15' (1 day)
Performance calculation	1 hour
Briefing	1 hour
Debriefing	1 hour

Documentation

Documentation may be lent to all participants at the beginning of the training

F TCAS Traffic Collision Avoidance System

Prerequisites

Flight Crew members only

Course Duration

2 hrs

Course Location

Prague, Czech Republic (Air Crew Training)

Language

Czech, English

Description

The Traffic Collision Avoidance System consists of the following topics:

Purpose, use, principle
Technical specification - display
Procedures
Air spacing responsibility
Phraseology
Crew operation - recommended RA procedures
Flight Report

Documentation

None

F CFIT

Control Flight Into Terrain

Prerequisites

Flight Crew members only

Course Duration

2 hrs

Course Location

Prague, Czech Republic (Air Crew Training Centre)

Language

Czech, English

Description

Controlled Flight Into Terrain - unintentional impact into terrain during a standard flight of aircraft and CRW. The "biggest" killer in aviation history.

Contents: definition and statistics

Causes: human factor, communications, situation awareness, fatigue, chapter of failures, visual illusions, infringement of procedures

Prevention: training and operation procedures, emergency manoeuvre CFIT, CFIT checklist, usage of automatization

Documentation

None

Prerequisites

All flight crew who will operate in RVSM space and territory

Course Duration

3 hrs

Course Location

Prague, Czech Republic (Air Crew Training)

Language

Czech, English

Description

RVSM classroom course is an option course and is usually attached to the Type Rating/Conversion Course. The aim of RVSM course is to train flight crew members for operation in RVSM airspace.

Knowledge and understanding of standard ATC phraseology used in each area of operations

Importance of crew members cross checking to ensure that ATC clearances are promptly and correctly complied with

Use and limitations in terms of accuracy of standby altimeters in contingencies

Problems of visual perception of other aircraft at 300m/1000ft planned separation during darkness, when encountering local phenomena such as northern lights, for opposite and same direction traffic, and during turns

Characteristics of aircraft altitude capture systems which may lead to overshoots

Relationship between the aircraft's altimetry, automatic altitude control and transponder systems in normal and abnormal conditions

Any airframe operating restrictions, if required for the specific aircraft group, related to RVSM airworthiness approval

Final written test

Documentation

None

F CRM Course

Crew Resource Management Initial

Prerequisites

This course is designed for Flight Crew only

Course Duration

2 days (16hrs)

Course Location

Prague, Czech Republic (Air Crew Training Centre)

Language

Czech, English, Russian

Description

The objective of the Crew Resource Management is to enhance the communication and management skills of the flight crew members. The emphasis is placed on the non-technical aspects of flight crew performance.

Crew Resource Management is the effective utilisation of all available resources (e.g. crew members, aeroplane systems and supporting facilities) to achieve safe and efficient operation.

The syllabus of the Initial CRM training is compiled in accordance with the EU-OPS IEM 1.945(a)(9), 1.955 (b) (6) a 1.965 (e) and its contents is described in the following topics:

Classroom Training

Introduction, statistics and examples of human factor related accidents	2 hrs
Situational awareness	2 hrs
Management of workload, tedium, tiredness or fatigue, vigilance and stress	2 hrs
Personality type, task delegation, leadership, effective communication	2 hrs
Human perception and learning process	1 hr
Operator's standard operating procedures	1 hr
Error chain and taking actions to break the error chain	1 hr
The CRM loop	1 hr
Implications of automation on CRM	1 hr
Effective communication and coordination within the crew and among crew members and other operational personnel	2 hrs
Joint training of course participants with cabin crew	1 hr

Documentation

PowerPoint presentation handout

Prerequisites

This course is designed for Flight Crew only

Course Duration

4 hrs in triennial cycle (3 volumes)

Course Location

Prague, Czech Republic (Air Crew Training Centre)

Language

Czech, English, Russian

Description

Volume 1 - 1st year

Communication and coordination inside and outside the cockpit

Human error and reliability

Automation

Volume 2 - 2nd year

Leadership

Decision making

Information acquisition and processing

Volume 3 - 3rd year

Stress

Task Management

SOP, organisation factors

For all volumes common topics

Statistics and examples of human factor related accidents

Case base studies

Combined training for FC and CC

Documentation

PowerPoint presentation handout

Prerequisites

This course is designed for Flight Crew

Course Duration

5 hrs

Course Location

Prague, Czech Republic (Air Crew Training)

Language

Czech, English

Description

The aim of the Dangerous Goods Initial Course is to train participants in procedures regarding Air Transport of Dangerous Goods.

Training topics for Flight Crew as given by ICAO Technical Instructions for the Safe Transport of Dangerous Goods by Air.

Initial Training consists of the following topics:

- General philosophy
- Limitations
- List of dangerous goods
- Labelling and marking
- Recognition of Undeclared Dangerous Goods
- Storage and loading procedures
- Notification to Pilot in Command
- Provisions for passengers and crew
- Emergency procedures

Documentation

Dangerous Goods Recommended Practices Handout
Air Transport of Dangerous Goods Textbook

Prerequisites

This course is designed for Flight Crew only

Course Duration

4 hrs

Course Location

Prague, Czech Republic (Air Crew Training)

Language

Czech, English

Description

Training topics for Flight Crew as given by ICAO Technical Instructions for the Safe Transport of Dangerous Goods by Air and IATA Dangerous Goods Regulations.

Recurrent Training consists of the following topics:

- General philosophy
- Limitations
- List of dangerous goods
- Labelling and marking
- Recognition of Undeclared Dangerous Goods
- Storage and loading procedures
- Notification to Pilot in Command
- Provisions for passengers and crew
- Emergency procedures

Documentation

Dangerous Goods Recommended Practices Handout
Air Transport of Dangerous Goods Textbook

Prerequisites

The Course is designed for crew members only.

Course Duration

1-2 days (min. 10-11 hrs)

Course Location

Prague, Czech Republic (Air Crew Training)

Language

Czech, English

Description

The aim of the Security Initial Course is to train participants in procedures regarding aviation security, especially with regard to procedures of Flight Crew and Cabin Crew.

Training is consists of the following two parts:

Day 1 – Integrated Security Training (duration 4 hrs) including following lessons:
classroom training (4 hrs).

Day 2 – Specialized Security Training (duration 7 hrs as a minimum) including following lessons: classroom training (6 hrs) and practical demonstration of pre-flight aircraft security check (identical aircraft type operated by customer is required).

Training techniques: Power Point Presentation, DVD TV, Handouts, Group Work, practical training (restraining techniques, aircraft security check).

Training is performed according to IATA Security Manual, Annex 17, National Security Training Program of Czech Republic, Security Programme of Czech Airlines.

Classroom training also includes:

- Security, Rescue and Emergency Services
- Security requirements
- Action to prevent acts of unlawful interference
- Reporting acts of unlawful interference
- Negotiation skills
- Aircraft search procedure checklist
- Final written test

Documentation

Tokyo Convention
Power Point Presentation Handout

Note: practical demonstration of pre-flight security check shall be carried out on identical aircraft type operated by customer.

It is recommended to coordinated all details in advance!

Prerequisites

Course is designed for Flight Crew only

Course Duration

3 hrs

Course Location

Prague, Czech Republic (Air Crew Training)

Language

Czech, English

Description

The aim of the Security Initial Course is to train participants in procedures regarding aviation security, especially with regard to procedures of Flight Crew and Cabin Crew.

Training techniques: Power Point Presentation, DVD, TV, Handouts, Group Work

Recurrent Course is performed according to IATA Security Manual, Annex 17 and Czech Airlines Training Programme and consists of the following topics:

- Security, Rescue and Emergency Services
- Security requirements
- Actions to prevent acts of unlawful interference
- Reporting acts of unlawful interference
- Negotiation skills
- Aeroplane search procedure checklist
- Final written test

Documentation

Power Point Presentation Handout

Prerequisites

This course is designed for Cabin Crew and Flight Crew

Course Duration

2 or 3 hrs

Course Location

Prague, Czech Republic (Air Crew Training), Swimming pool in the vicinity of Prague

Language

Czech, English

Description

The aim of the Water Survival Training is to train participants in water survival techniques and use of adequate survival equipment.

Training techniques: Instruction, Water Practical Training

The course takes 2 hours (without A321 slide-raft training) or 3 hours (with A321 slide-raft training) and consists of the following topics:

- General principles

- Life vests (RDF, Air cruisers)

- Equipment of slide raft A321

- Practical training in water using life vests and slide raft (optional)

Documentation

None

Prerequisites

This course is designed for Flight Crew

Course Duration

5 hrs

Course Location

Prague, Czech Republic (Air Crew Training)

Language

Czech, English

Description

The aim of the Fire Fighting and Smoke Training Course is to train participants in prevention and extinguishing of fire and use of fire fighting equipment on board an aircraft.

Training techniques: Instruction, Video TV, Power Point Presentation, Handouts, Fire Fighting Trainer, B 737 Cabin Emergency Evacuation Trainer

The Course consists of the following topics:

- General principles

- Prevention of fire

- Possible sources of fire in a/c

- Fire extinguishers (Halon, Water)

- PBE (Personal Breath Equipment, PBR) and other equipment

- Extinguishing of real fire using Fire Fighting Trainer

- Crew coordination using B737 Cabin Emergency Evacuation Trainer

Documentation

None

Prerequisites

This recurrent course is designed for Flight Crew members

Course Duration

3 hrs

Course Location

Prague, Czech Republic (Air Crew Training)

Language

Czech, English

Description

The objective of this training is to revise knowledge of all procedures regarding to Fire Fighting and Water Survival (use of lifejacket and relating procedures).

This training consists of:

Actual donning of protective breathing equipment (demonstration smoke effects in enclosed area and actual use of all relevant in simulated smoke – filled environment).

Actual donning of fire extinguishers (extinguishing of actual fire on Fire Fighting Simulator).

Actual donning of lifejackets and procedures relating to water survival.

Documentation

None

Note: as emergency and safety equipment might be variable and differs from airline to airline it is recommended to inform us about more technical details of your equipment to ensure high quality of the training.



Cabin Crew Courses

Prerequisites

None

Course Duration

15 days (117 hrs)

Course Location

Prague, Czech Republic (Air Crew Training)

Language

Czech, English

Description

The aim of the Initial Safety Training is to acquire the knowledge and skills required for the issue of the Cabin Crew atestation, to acquire the knowledge necessary for the performance of activities and fulfilment of duties concerning regular flight operations and regular airplane operations and to acquire the knowledge to communicate in Czech / English languages on board airplane.

Training techniques: Instruction, video TV, Power Point Presentation, Handouts, Lectures, Group Work, Fire Fighting Trainer, B737 Cabin Emergency Evacuation Trainer, Swimming Pool

The Initial Safety Training consists of the following topics:

Fire fighting and smoke training	4 hrs
Water survival training	1 hr
Survival training - ground (polar, desert, jungle) and sea	2 hrs
Medical aspects and first aid training	34 hrs
Dangerous goods	5 hrs
Security procedures	7-11 hrs
Crowd Control	4 hrs
Stowing	2 hrs
Transport regulations	12 hrs
Position performance	12 hrs
Flight time limitations	4 hrs
General knowledge of aviation and responsibilities	5 hrs
Meteorology	2 hrs
CRM (Crew Resource Management)	16 hrs
Special differences among nations, Grooming and aesthetics	6 hrs

Documentation

Training Manual for Initial Course

Dangerous Goods – recommended practices handout

Security procedures handout

First aid procedures handout

Prerequisites

Completed Initial Training for Cabin Crew

Course Duration

3 days (21 hrs)

Course Location

Prague, Czech Republic (Air Crew Training)

Language

Czech, English

Description

The aim of the Conversion Training for ATR 42/72 is to train Cabin Crew for performing Cabin Crew position.

Training techniques: Instruction, video TV, Power Point Presentation, Handouts, Lectures, Aircraft Field Visit, Group Work, Fire Fighting Trainer, Swimming Pool.

The Conversion Training consists of the following topics:

Aeroplane description – general characteristic	2 hrs
Emergency and safety equipment	3 hrs
Realistic training and demonstration of safety equipment use	2 hrs
Aeroplane seeing	4 hrs
Pilot incapacitation	1 hr
Operation of door and exits	1 hr
Evacuation procedures and emergency situations	2 hrs
Crowd control	1 hr
Water survival training – practical training in water	1 hr
Passenger briefing and safety demonstrations	1 hr
CRM (Crew Resource Management)	2 hrs
Final written test	1 hr

Documentation

Training Manual for Conversion Course ATR 42/72

Prerequisites

Completed Initial Training for Cabin Crew

Course Duration

4 days (29 hrs)

Course Location

Prague, Czech Republic (Air Crew Training)

Language

Czech, English

Description

The aim of the Conversion Training for B737 - 400/500 is to train participants for Cabin Crew position.

Conversion Training fulfils the requirements of EU-OPS 1.1010 and Training Programme of Czech Airlines.

Training techniques: Instruction, video TV, Power Point Presentation, Handouts, Lectures, Aircraft Field Visit, Group Work, B737 Cabin Emergency Evacuation Trainer, Fire Fighting Trainer (optional), Swimming Pool.

The Conversion Training consists of the following topics:

Aeroplane description - general characteristic	2 hrs
Emergency and safety equipment	4 hrs
Realistic training and demonstration of safety equipment	4 hrs
Aeroplane seeing	5 hrs
Pilot incapacitation	1 hr
Operation of doors and exits	2 hrs
Evacuation slide training	1 hr
Fire and smoke training	3 hrs
Evacuation procedures and emergency situations	3 hrs
Crowd control	1 hr
Water survival training – practical training in water	1 hr
Passenger briefing and safety demonstrations	1 hr
CRM (Crew Resource Management)	2 hrs
Final written test	1 hr

Documentation

Training Manual for Conversion Course B737-400/500

C 320CC

Conversion Course for A 319/320/321

Prerequisites

Finished Initial training for Cabin Crew

Course Duration

3 days (21 hrs)

Course Location

Prague, Czech Republic (Air Crew Training)

Language

Czech, English

Description

The aim of the Conversion Training for A 319/320/321 is to train Cabin Crew for performing Cabin Attendants position.

Conversion Training fulfils the requirements of EU OPS 1.1010 and Training Programme of Czech Airlines.

Training techniques: Show, video TV, Power Point Presentation, Handouts, Lectures, Aircraft Field Visit, Group Work, Cabin Emergency Evacuation Trainer, Fire Fighting Trainer (optional), Swimming Pool.

The Conversion Training consists of the following topics:

Aeroplane description – general characteristic	4 hrs
Emergency and safety equipment	2 hrs
Realistic training and demonstration of safety equipment use	3 hrs
Aeroplane seeing	3 hrs
Pilot incapacitation	0.5 hr
Operation of door and exits	1 hr
Evacuation slide training	1 hr
Evacuation procedures and emergency situations	1 hr
Crowd control	1 hr
Water survival training – practical training in water	0.5 hr
Passenger briefing and safety demonstrations	1 hr
CRM (Crew Resource Management)	2 hrs
Final written test	1 hr

Documentation

Training Manual for Conversion Course A319/320/321

Prerequisites

The Course is designed for crew members only.

Course Duration

1-2 days (min. 10-11 hrs)

Course Location

Prague, Czech Republic (Air Crew Training)

Language

Czech, English

Description

The aim of the Security Initial Course is to train participants in procedures regarding aviation security, especially with regard to procedures of Cabin Crew.

Training consists of the following two parts:

Day 1 – Integrated Security Training (duration 4 hrs) including following lessons: airport security site tour or security training movie (1 hr) and classroom training (3 hrs).

Day 2 – Specialized Security Training (duration 7 hrs as a minimum) including following lessons: classroom training (6 hrs) and practical demonstration of pre-flight aircraft security check (identical aircraft type operated by customer is required).

Training techniques: Power Point Presentation, DVD TV, Handouts, Team Work, practical training (restraining techniques, aircraft security check).

Training is performed according to IATA Security Manual, Annex 17, National Security Training Program of Czech Republic, National Security Training Programme of Czech Airlines.

Classroom training also includes:

- Security, Rescue and Emergency Services
- Security requirements
- Action to prevent acts of unlawful interference
- Reporting acts of unlawful interference
- Negotiation skills
- Aircraft search procedure checklist
- Final written test

Documentation

Tokyo Convention
Power Point Presentation Handout

Note: practical demonstration of pre-flight security check shall be carried out on identical aircraft type operated by customer.

It is recommended to coordinated more details in advance!

Prerequisites

Course is designed for Cabin Crew only

Course Duration

3 hrs

Course Location

Prague, Czech Republic (Air Crew Training)

Language

Czech, English

Description

The aim of the Security Recurrent Training is to enhance knowledge regarding to aviation security procedures and role of cabin crew in protection civil aviation against unlawful acts..

Training techniques: Power Point Presentation, DVD TV, Handouts, Group Work

Recurrent Course is performed according to IATA Security Manual, Annex 17 and Czech Airlines Training Programme and consists of the following topics:

- Security, Rescue and Emergency Services
- Security requirements
- Action to prevent acts of unlawful interference
- Reporting acts of unlawful interference
- Negotiation skills
- Aeroplane search procedure checklist
- Final written test

Documentation

Power Point Presentation Handout

C ESE Training

Emergency and Safety Procedures

Prerequisites

This course is designed for Cabin Crew

Course Duration

6 hrs

Course Location

Prague, Czech Republic (Air Crew Training)

Language

Czech, English

Description

The aim of the Emergency and Safety Procedures Training Course is to train participants in equipment and procedures regarding Safety and Emergency on board aircraft.

It is recommended to join this course with the Fire fighting course (5 hours) and Water survival course (in 2 or 3 hours).

The Emergency and Safety Procedures Course consists of the following items:

- Portable equipment
(Oxygen devices, PBE – Protective Breath Equipment, fire extinguishers, life vests, etc)
- Stationary oxygen systems
- Emergency lightning systems
- Emergency exits (B737, ATR42/72, A 319/320/321)
- Slides, Slide-rafts, practical use on the ground or optionally in water
- Emergency evacuation techniques
- Pilot Incapacitation

Documentation

None

Prerequisites

This course is designed for Cabin Crew only

Course Duration

4 days (32hrs)

Course Location

Prague, Czech Republic (Air Crew Training)

Language

English, Czech

Description

The aim of Cabin Crew Instructor Course is to acquire the Qualification of a Cabin Crew Instructor.

Training techniques: Power Point Presentation, Handouts, Lectures.

The Course consists of following topics:

International aviation organizations	0.5 hr
Administrative authorities in civil aviation	0.5 hr
EU-OPS 1	8 hrs
Operator's Operations Manual* (approx.)	7 hrs
Teaching process and Teaching methods	5 hrs
Assessing and examining a student	1 hr
Familiarization flights, in-flight checking and training administration	2 hrs
Crew Resource Management	8 hrs

* Should be consulted with operator

Documentation

Printed extracts of EU-OPS (ES č. 859/2008)

Prerequisites

This course is designed for Cabin Crew who has successfully completed Conversion and Differences Course for ATR 42/72, B737-500/400 and A 319/320/321 and their break in flying is from 6 to 42 months.

Course Duration

6 hrs

Course Location

Prague, Czech Republic (Air Crew Training)

Language

Czech, English

Description

The aim of the Refresher Training Course is to continuously maintain the Cabin Crew qualification.

Training techniques: Instruction, Video TV, Power Point Presentation, Handouts, B 737 Cabin Emergency Evacuation Trainer.

The Refresher training consists of the following topics:

- Operation and practical opening of all normal and emergency exits for passengers evacuation and demonstration of operation of all other exits using door trainers
- B737 Cabin Emergency Evacuation Trainer and aircraft
- Location and handling of emergency equipment
- Emergency evacuation procedures
- Methods of crowd control
- Pilot incapacitation

Documentation

None

C CRMI Course

Crew Resource Management Initial

Prerequisites

This course is designed for Flight Crew only

Course Duration

2 days (16 hours)

Course Location

Prague, Czech Republic (Air Crew Training Centre)

Language

Czech, English, Russian

Description

The objective of the Crew Resource Management is to enhance the communication and other skills to perform flight safely. The emphasis is placed on the non-technical aspects of cabin crew performance.

Crew Resource Management is the effective utilisation of all available resources (e.g. crew members, aeroplane systems and supporting facilities) to achieve safe and efficient operation.

Classroom Training

Introduction, statistics and examples of human factor related accidents	2 hrs
Situational awareness	2 hrs
Management of workload, tiredness or fatigue, vigilance and stress	2 hrs
Personality type, task delegation, leadership, effective communication	2 hrs
Human perception and learning	1 hr
Operator's standard operating procedures	1 hr
Error chain and taking actions to break the error chain and problem solving process	1 hr
The CRM loop	1 hr
Effective communication and coordination within the crew and among crew members and other operational personnel	2 hrs
Team work	1 hr
Influence of company	1 hr

Documentation

None

Prerequisites

This course is designed for Cabin Crew only

Course Duration

4 hrs in triennial cycle (3 volumes)

Course Location

Prague, Czech Republic (Air Crew Training Centre)

Language

Czech, English, Russian

Description**Volume 1 – 1st year**

Personality awareness, human error and reliability, attitudes and behaviours, self assessment.

Stress and stress management

Error prevention and detection.

Shared situation awareness, information acquisition and processing

Workload management.

Company safety culture, SOP's, organisational factors, factors linked to the type of operations.

Case based studies

Volume 2 – 2nd year

Fatigue and vigilance.

Assertiveness.

Effective communication and co-ordination between all crew members including the flight crew as well as inexperienced cabin crew members, cultural differences.

Leadership, co-operation, synergy, decision making, delegation.

Individual and team responsibilities and actions.

Effective communication and coordination with other operational personnel and ground services.

Case based studies.

Volume 3 – 3rd year

Situational awareness, information acquisition and processing.

Identification and management of the passengers human factor: crowd control, passenger stress, conflict management, medical factors.

Specific to aeroplane types (narrow /wide bodies, Flight crew and cabin crew composition and number of passengers).

Participation in cabin safety incident and accident reporting.

Case based studies

Documentation

None

Prerequisites

This course is designed for Cabin Crew

Course Duration

5 hrs

Course Location

Prague, Czech Republic (Air Crew Training)

Language

Czech, English

Description

The aim of the Dangerous Goods Initial Course is to train participants in procedures regarding Air Transport of Dangerous Goods.

Training topics for Flight Crew as given by ICAO Technical Instructions for the Safe Transport of Dangerous Goods by Air.

Initial Training consists of the following topics:

- General philosophy
- Limitations
- List of dangerous goods
- Labelling and marking
- Recognition of Undeclared Dangerous Goods
- Storage and loading procedures
- Notification to Pilot in Command
- Provisions for passengers and crew
- Emergency procedures

Documentation

Dangerous Goods Recommended Practices Handout
Air Transport of Dangerous Goods Textbook

Prerequisites

This course is designed for Cabin Crew only

Course Duration

4 hrs

Course Location

Prague, Czech Republic (Air Crew Training)

Language

Czech, English

Description

Training topics for Flight Crew as given by ICAO Technical Instructions for the Safe Transport of Dangerous Goods by Air and IATA Dangerous Goods Regulations.

Recurrent Training consists of the following topics:

- General philosophy
- Limitations
- List of dangerous goods
- Labelling and marking
- Recognition of Undeclared Dangerous Goods
- Storage and loading procedures
- Notification to Pilot in Command
- Provisions for passengers and crew
- Emergency procedures

Documentation

Dangerous Goods Recommended Practices Handout
Air Transport of Dangerous Goods Textbook

C CRMIN Course

Crew Resource Management Instructor

Prerequisites

This course is designed for Cabin Crew only

Course Duration

8 hrs

Course Location

Prague, Czech Republic (Air Crew Training Centre)

Language

Czech, English, Russian

Description

CRM goals and objectives

3 hrs

Teaching process and Teaching methods

2 hrs

- Initial course composition

2 hrs

- Recurrent course composition

1 hr

Documentation

None

C FFST Course

Fire Fighting and Smoke Training

Prerequisites

This course is designed for Cabin Crew

Course Duration

5 hrs

Course Location

Prague, Czech Republic (Air Crew Training)

Language

Czech, English

Description

The aim of the Fire Fighting and Smoke Training Course is to train participants in prevention and extinguishing of fire and use of fire fighting equipment on board an aircraft.

Training techniques: Instruction, Video TV, Power Point Presentation, Handouts, Fire Fighting Trainer, B 737 Cabin Emergency Evacuation Trainer

The Course consists of the following topics:

- General principles

- Prevention of fire

- Possible sources of fire in a/c

- Fire extinguishers (Halon, Water)

- PBE (Personal Breath Equipment, PBR) and other equipment

- Extinguishing of real fire using Fire Fighting Trainer

- Crew coordination using B737 Cabin Emergency Evacuation Trainer

Documentation

None

Prerequisites

The course is designed for Cabin Crew members only

Course Duration

4 days

Course Location

Prague, Czech Republic (Air Crew Training)

Language

Czech, English

Description

The aim of the Medical Aspects and First Aid Training is to train participants for case of in flight health emergencies of passengers and crewmembers.

Training techniques: Power Point Presentation, Group Work

Ground and classroom training takes 4 days (32 hours) and is designed according to IEM to Appendix 1 to EU-OPS 1.1005.

This course consists of following topics:

Physiology of flight including oxygen requirements, and hypoxia

Choking

Stress reactions and allergic reactions

Hyperventilation

Gastro-intestinal disturbance

Airsickness

Epilepsy

Heart attacks

Stroke

Shock

Diabetes

Emergency childbirth

Asthma

The unconsciousness

Burns

Wounds

Fractures and soft tissue injuries

Practical CPR using a specifically designed dummy

The use of appropriate aeroplane equipment including first-aid kits and first-aid oxygen

Documentation

None

Prerequisites

The course is designed for Cabin Crew members only

Course Duration

3 hours

Course Location

Prague, Czech Republic (Air Crew Training)

Language

Czech, English

Description

The aim of the First Aid Recurrent Training is to refresh knowledge and skills of solving in flight health emergencies of passengers and crewmembers.

Training techniques: Power Point Presentation, Group Work

Ground and Classroom training takes 3 hours and is designed according to IEM to Appendix 1 to EU-OPS 1.1015.

This course consists of following topics:

Physiology of flight including oxygen requirements, and hypoxia

Choking

Stress reactions and allergic reactions

Hyperventilation

Gastro-intestinal disturbance

Airsickness

Epilepsy

Heart attacks

Stroke

Shock

Diabetes

Emergency childbirth

Asthma

The unconsciousness

Burns

Wounds

Fractures and soft tissue injuries

Practical CPR using a specifically designed dummy

The use of appropriate aeroplane equipment including first-aid kits and first-aid oxygen

Documentation

None

FC ESE G Training

Emergency and Safety Procedures

Prerequisites

This course is designed for Flight Crew and Cabin Crew

Course Duration

4 hrs

Course Location

Prague, Czech Republic (Air Crew Training)

Language

Czech, English

Description

The aim of the Emergency and Safety Procedures Training Course is to provide to participants general knowledge in equipment and procedures regarding Safety and Emergency on board an aircraft.

It is recommended to join this course with the Fire fighting course (5 hours) and Water survival course (in 2 or 3 hours).

The Emergency and Safety Procedures Course consists of the following items:

- Portable equipment
(Oxygen devices, PBE – Protective Breath Equipment, fire extinguishers, life vests, etc)
- Stationary oxygen systems
- Emergency lightning systems
- Emergency evacuation techniques
- Pilot Incapacitation

This training is not related to specific aircraft type.

Training Aids

CEET, door trainers, Oxygen devices, PBE – Protective Breath Equipment, fire extinguishers, life vests,

Documentation

None

CSA Air Crew Training

The CSA Air Crew Training (ACT) is situated in Hangar B, at Prague Ruzyne-South Airport. We provide specialized air crew training not only for CSA crews, but also for the crews of other airlines from the Czech Republic and abroad. All training is carried out according to current rules and regulations, namely, EU-OPS , JAR-FCL 1 as well as training plans approved by the Czech Civil Aviation Authority. The Air Crew Training is a Czech CAA approved Type Rating Training Organisation (TRTO) for all the aircraft types operated by CSA (Airbus 319/320/321, Boeing 737 and ATR 42/72).

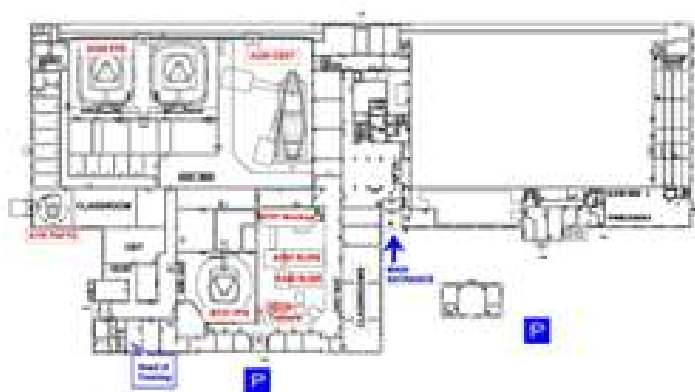

Training facilities and equipment

Air Crew Training is equipped with up-to-date training facilities. The modern premises house a Boeing 737-400/500 and A320 Full Flight Simulators and also FTD ATR42/72 and MFTD A320 training devices. In addition to this, there are Cockpit Procedure Trainers for all the aircraft types operated by Czech Airlines, i.e., Boeing 737 and ATR 42/72. A Boeing 737 and A320 Cabin Crew Emergency and Evacuation Trainer (CEET) is used for cabin crew training, covering in-flight services, fire-fighting, rapid cabin decompression and emergency evacuations. A specialized CBT classroom is used for the self-paced individual training of air crew members, as well as of ground technical staff. All classrooms are equipped with modern audio-visual teaching aids, such as overheads, video players with TV monitors, personal computers and data and video projectors.

Wet & Dry Leasing

Air Crew Training provides all types of training under the leadership of highly qualified instructors, using either the standards set by CSA or specially-tailored training courses according to a particular customer's needs (Wet Leasing). Training can be carried out in either English or Czech, and in some instances, in Russian as well. Optionally, all training equipment may be used by the customer's own instructors (on a "Dry" leasing basis) – after they have received the appropriate training.

Flight Simulators and flight training devices

Air Crew Training has flight simulators and other flight training devices for the following aircraft types: B737, A320, ATR72/42. They are used especially for flight crew training, but also for cabin attendant training and for “funny flying” by a paying public. Full Flight Simulators (FFS) are simulators with the 6 DOF motion base and may also be used as FBS – Fixed Based Simulators. They can closely simulate all weather conditions, aircraft motions and avionic systems. A sophisticated visual system can simulate many world airports.

Flight Training Devices (FTD) are used for pilot training and are very similar to full flight simulators. The FTD ATR 72/42 is a flight simulator without a motion base. Other functions are similar to those of the FFS. The MFTD A320 is very similar and allows aircraft engineer training too.

Cockpit Procedure Trainers (CPT) are additional flight crew cockpit identification devices and are used for flight crew procedures training. The actual panel is replaced with simple pictures or photographs. Important controls are available in 3D.

B737 Flight Simulator

The Boeing 737-400/500 Full Flight Simulator (FFS) with the 6 DOF motion base may also be used as a FBS – Fixed Based Simulator.

The FFS was approved and certified as ready for training in July 2000. In addition to the six DOF motion base it also has the most modern MaxVue Plus visual system. The cockpit was adapted according to the CSA's B737 fleet standards and newly equipped with TCAS II, Traffic Collision Avoidance Systems and WX radar simulation systems (including corresponding effects in the visual system).

FFS Technical Specifications:

- Manufacturer: CAE Electronics Ltd.
- Aircraft Type: Boeing 737-400/500
- Aerodynamics Data: Rev. A
- Control Forces Data: Rev.A
- Engine Type: CFM56-3C
- FMC (Flight Management Computer) Part No.: Smiths Ind. P/N 176200-01-01 (U10.5)
- Autopilot type: SP-300
- Visual System: MaxVue Plus 180 deg.
- 3 channel continuous
- Motion System: 6 DOF 500 Series
- Certification: Level CG according to JAR-STD-1A*
- Zero Flight Time Type Rating approval



*) The FFS certification was done according to the European JAR-STD-1A standards; both the Motion and Visual systems fully comply with the Level D standard and were certified so.

A320 Flight Simulator

The Airbus A320 Full Flight Simulator (FFS) with the 6 DOF motion base may also be used as a FBS – Fixed Based Simulator. In addition it also has the most modern VITAL 8 Plus visual system.

FFS Technical Specifications:

- Manufacturer: THALES
- Aircraft Type: A320
- Engine Type: CFM56/IAE V2527
- Visual System: E&S EP-1000CT/ESCP-2000
- Motion System: Hydraulic 6 DOF
- Certification: Level D according to JAR STD 1A
- Zero Flight Time Type Rating approval



ATR 42/72 Flight Training Device

FTD ATR42/72 (Flight Training Device) is used for pilot training. Up to half of the entire simulator training will be available on this device for type training and MCC training. We plan to use the device for CSA flight crew training and the training of external customers. The device will replace the FBS part of training.

Technical Specifications:

- Manufacturer: MECHTRONIX SYSTEMS
- Aircraft Type: ATR42/72
- Engine Type: PW127E/PW127F
- Visual System: MSI INSIGHT, 180°x 40°FOV
- Computer: PC
- Certification: FTD level 2/FNTP II MCC (JAR-STD 2A/3A)



A320 Maintenance and Flight Training Device

The MFTD A320 (Maintenance and Flight Training Device) is used for pilot and ground engineer training for A320's. It allows trainees to practise all procedures and thus improves the quality of training.

Technical Specifications:

- Manufacturer: CAE Electronics Ltd.
- Aircraft Type: A320
- Engine Type: CFM56/IAE V2527
- Computer: PC
- Certification: FTD level JAR-STD 2A



Cockpit Procedure Trainers – CPTs

CPTs (Cockpit Procedure Trainers) are used as supplementary training devices for cockpit identification as well as cockpit procedure training. Instrument panels are generally replaced by simple, flat (two-dimensional) drawings or photos, but important controls are provided as three-dimensional and some of them as partially functional. Air Crew Training is equipped with CPTs for CSA operated aircraft types (B737-500, and ATR). Training is carried out on the following trainers:

- Boeing 737 cockpit procedure trainer
- ATR cockpit procedure trainer

Emergency training

Emergency procedures training prepares both cockpit and cabin crews to handle potential emergency situations, such as emergency landings, forced landings on water, or fires on board – making certain that even if a worst-case scenario occurs, everything runs smoothly. All standard training programmes were approved by the Czech Civil Aviation Authority. Theoretical training is backed up by CBT computer-assisted learning programmes and videos. Particular emphasis is laid down on drilling emergency procedures in the B737 Cabin Emergency Evacuation Trainer (CEET B737) or CEET A320. Other special trainers for CSA operated airplane types may also be used. All the relevant rescue equipment is involved in practice drills.

Cabin Emergency and Evacuation Trainer - CEET B737

The CEET Boeing 737 allows the improving of the quality and effectiveness of cabin attendant training. Training contains especially the following procedures:

Handling of the cabin door

Passenger announcements through the public address system.

Communication with the cockpit and other cabin attendant positions.

Use of emergency and life saving equipment, first aid.

Fire-fighting at various places in the cabin.

Non-standard situation activities (i.e., hijacking of the aircraft, etc.).

Preparation of passengers for an emergency landing, emergency evacuation of the aircraft.

Joint cabin and flight Crew Resource Management.

All the controls in the cabin used by the cabin attendants are fully functional, or their functions are fully simulated for these purposes. The CEET B737 is also equipped with a cockpit replica where the only functioning controls and signalling devices are those used for the cabin control or for communication with the cabin crew.

Basic technical specifications

In the mock-up cabin there are seats for:

- 30 passengers
- 5 cabin attendants
- 2 pilots
- 1 instructor



Cabin Emergency and Evacuation Trainer - CEET A320

The CEET A320 makes possible an improvement in the quality and efficiency of Flight and Cabin Crew training for A 320/321/319 aircraft. The following components are installed:

- Motion, Visuals, Video, and a Sound System enable the simulation of a flight and emergency situation
- A cockpit section with fully-functional pilots seats, oxygen masks for pilots, a left side moveable window and communication system
- A cabin section with galleys, lavatories, functional bins and passenger seats
- Door operation, with selectable malfunctions for the AC doors and slides
- Slide "single line" at door 1L
- Slide "dual line" at Over Wing Exit - LH
- Main Entry Door 1L
- Door 2R for A 321 (without slide)
- Fully functional emergency exit type III
- Fire/Smoke simulation at 6 locations
- Rapid decompression with oxygen mask release
- Indication of evacuation and smoke alert
- Functional cabin and emergency lighting
- All functions of the CEET are controlled via touch-screen monitors at the Instructor Operation Station.

Basic technical data

- 41 passenger seats
- Instructor Operation Station
- Seats for 3 cabin crew, 2 pilots, 2 instructors
- Producer: TFC
- Motion system: Rexroth HSE 3-MS-71



Fire Simulator

In the B737 Cabin Mock-up, fire-fighting of a simulated fire (by smoke and light) can be practised in the circumstances of real air transport conditions (passengers, a realistic cabin interior), while in the Cabin Fire Simulator, fire-fighting of real fire in a closed space can be practised. A particular goal of this training is to remove potential inhibitions about a real fire, especially within a narrow, closed space. Flame intensity can be set by the instructor so as to allow for a gradual increase in both mental and physical strain on the trainee and the level of training in circumstances close to the real conditions of an aircraft cabin.

The Cabin Fire Simulator satisfies in full all the requirements for fire-fighting training in terms of the EU-OPS 1.1010 rules and regulations, including corresponding annexes for conversion, difference and recurrent training. The device provides reasonable safety and protection for the trainees and has a minimum negative influence on the environment.



CRM – Crew Resource Management

“Human Factors” are always decisive wherever a group of people performs highly responsible tasks in a high-tech setting. This is just as much the case with cockpit crews as it is with, for example, teams in operating theatres. Therefore, our Crew Resource Management (CRM) course focuses on the following:

- Introduction, statistics and examples of human factor related accidents.
- Situational awareness.
- The Operator’s standard operating procedures.
- The error chain and taking actions to break the error chain.
- CRM loop.
- Implications of automation on CRM.
- Effective communication and coordination within the crew and between crew members and other operational personnel.



The CSA CRM effort is focused not only on cockpit crews but on cabin crews as well and on the cooperation between both groups. We have developed various standard basic courses as well as a refresher CRM course. Furthermore, we offer specially-tailored CRM courses fine-tuned to the client's specific needs.

CBT - Computer Based Training

Computer Based training uses touch-screen computer monitors along with audio presentation mainly for the self-paced individual training of pilots, however, it can be used for cabin attendants, ground technical staff and other airline personnel training as well. All CBT programmes are in English, allowing easy transition according to the customer’s needs.



Customer airline pilots come to CSA for both type and recurrent training and Air Crew Training has prepared several training programmes for these purposes. The entire theoretical part of the type training courses for all planes operated by CSA (A320, B737 and ATR) is on CBT. The use of CBT provides great flexibility for the planning of training.

Specialized CBT training rooms can be used for the individual training of air crews as well as ground technical personnel and each and every participant may choose his/her own pace. Available are training programmes for ATR, A320 and B737 and also some specialized training programmes for pilots, cabin attendants and aircraft engineers.

Other activities

During those times when the Czech Airlines flight simulators are not being used for training pilots, a flight on some of them may be booked. Simulator flying is carried out under the supervision of experienced instructors and is meant for the professional public as well as other interested persons who want to have fun flying to some very interesting airports.



General programme

General familiarization with the airplane and its cockpit, brief information about the full flight simulator
Demonstration of a flight at a selected airport, demonstration of flying
Demonstration of other airports and opportunities to fly in different weather conditions
Actual flying under the supervision of the CSA instructor.



There are a limited number of seats in the simulator cockpit – we recommend 3-4 persons as a maximum.
As the simulators are very busy with the training of pilots, it is necessary to book the excursion in advance. The minimum flying time is one hour. Flights are conducted on ATR, B737 and A320 simulators.



Full flight simulators, cabin mock-ups and other very interesting training devices are located in the Training Centre premises. Air Crew Training offers three basic types of paid excursions.

Simulator Flying “ Funny Flying”

Czech Airlines offers you FUNNY FLYING – flying on a simulator under the supervision of an experienced instructor. You can fulfil your childhood dream of flying a passenger airplane! This activity is meant not only for aviation specialists but also for the general public. The sophisticated CSA flight simulators allow for the experience of a very real flight under any weather conditions and you can fly not only at airports in the Czech Republic, but also around very interesting airports such as Zurich, Funchal, Innsbruck, etc.

Flying is available on the following simulators:

Airbus 320 – full flight
Boeing 737 – full flight
ATR 42/72 – immovable

What can you experience?

A sightseeing flight with an instructor
flying as you choose – just for fun.
Flying at interesting destinations (Zurich, etc.)
Flying in good or bad weather conditions (fog, rain, snow, etc.)
Instrument flying – flight-route flying
Approach and landing of real passenger aircraft
Flying with autopilot
Flying with an engine failure and other defects

A list of airports available in the simulators may be found in the “Airports” file

How to book a simulator flight?

As the flight simulators are very busy, it is necessary to book the date and time well in advance.

Then, a binding application form may be faxed or e-mailed to:

CSA Air Crew Training
Hangar B
K letišti
160 08 Prague 6 – Ruzyně

e-mail: katerina.hanouskova@csa.cz
or on 724 811 362 for A320, B737 types
tel.: + 420 220112213
fax: + 420 220112671

e-mail: petra.dvorakova@csa.cz
or on 602 695 658 for ATR 42/72 type



Prices

Simulator

Airbus 320 – 1 hour 15 000 CZK + 20%VAT

Boeing 737 – 1 hour 13 000 CZK + 20%VAT

ATR 42/72 – 1 hour 3 200 CZK + 20%VAT

Payment conditions

CSA will submit invoices to the buyer for the amounts for ordered Funny Flying and payment shall be made in the appropriate currency **in advance**. All needed payment information you can find in the invoice.

There has to be added 20% VAT to all net prices according to the tax law of the Czech Republic.

Other conditions:

CSA reserves the right to change the booked date for operational reasons

There is a limited number of seats in the simulator cockpit – a group of 3 persons as a maximum

Minimum time is 1 hour

Briefing – flight preparation, begins 30 minutes before flight.

When entering airport restricted areas, it is necessary to present an ID card or a passport

Participants have to submit their name, surname, date of birth, identity card number or passport number in writing, 5 days in advance as a minimum

Simulator flying participants shall observe all safety measures and follow the instructions of the instructor. If children below 10 years of age participate, the hydraulic movement of the simulator will not be switched on.

We would like to inform the participants that they will access the Airport Restricted Area where all security measures have to be observed. It is prohibited to bring any weapons, fake weapons or other objects which could be used to commit an act of unlawful interference.

Excursions

Full flight simulators, cabin mock-ups and other very interesting training devices are located on the Training Centre premises.

Air Crew Training offers three basic types of paid excursions:

Excursion I – 1 hour

During this excursion, an expert will inform you about the history of the Air Crew Training department, pilot and cabin crew training. There is also a short film showing the activities of our department. Then, the actual guided tour of the training devices takes place.

Excursion programme:

Presentation in a classroom – 10 minutes

Short film showing air crew training at CSA – 15 minutes

Guided tour of training devices – 35 minutes

Excursion II – 2 hours

This excursion contains an additional presentation of a pilot's work in an ATR simulator and a flight in an Airbus 320 cabin mock-up used for cabin attendant training.

Excursion programme:

Presentation in a classroom – 10 minutes

Short film showing air crew training at CSA – 15 minutes

Guided tour of training devices – 35 minutes

Presentation of pilot on ATR simulator and a sightseeing flight in the Airbus 320 cabin mock-up – 1 hour

Excursion III – 3 hours

This excursion contains an additional presentation of ATR aircraft basic data, a briefing on flying this airplane, and actual simulator flying under the supervision of an instructor.

Excursion programme:

Presentation in a classroom – 10 minutes

Short film showing air crew training at CSA – 15 minutes

Guided tour of training devices – 35 minutes

A flight in the Airbus 320 mock-up (about 20 minutes) and a flight in the ATR flight simulator – 2 hours

As capacity is limited, it is necessary to book your excursion dates well in advance. Taking photographs and amateur movie making is permitted. The participants meet at the Training Centre reception desk half-an-hour before the beginning of the excursion.

Other conditions

The participants have to submit their name, surname, date of birth, identity card number or passport number in writing, five days in advance as a minimum
The participants shall observe all safety measures and strictly follow the instructions of the excursion guide. If minors participate in the excursion, their accompanying person is responsible for their safety and conduct.

We would like to inform the participants that they will access the Airport Restricted Area where all security measures have to be observed. It is prohibited to bring any weapons, fake weapons or other objects which could be used to commit an act of unlawful interference.

Excursion dates: to be agreed upon by telephone

Prices:

Excursion I (1 hour) – minimum no. of participants, 10, maximum 20.

Adults	150 CZK
Children 3-15 years, retirees, students, disabled	70 CZK

Excursion II (2 hours) – minimum no. of participants, 10, maximum 15.

Price per group	14 400 CZK
-----------------	------------

Excursion III (3 hours) – minimum no. of participants, 10, maximum 15.

Price per group	22 000 CZK
-----------------	------------

Notice : Excursions II and III must be booked a month in advance as a minimum, in order to plan simulator capacity and an instructor.

Method of payment

CSA will submit invoices to the buyer for the amounts for ordered Excursions and payment shall be made in the appropriate currency **in advance**. All needed payment information you can find in the invoice.

There has to be added 20% VAT to all net prices according to the tax law of the Czech Republic.

Transport :

Your own, or Bus no. 100, 119, 179 to the “K Letišti” stop.

Coordinator: Kateřina Hanouskova

Contact: Tel. +420 220112213, Mobile: +420 724 811 362, Fax: +420 220112671, e-mail: katerina.hanouskova@csa.cz,

A flight on some of the simulators may be booked individually, if the available capacity allows, as Funny Flying.

General Terms and Conditions

Any purchase order of the services supplied by the CSA Air Crew Training Centre shall be governed by these Terms and Conditions.

Validity

These General Terms and Conditions form a part of any written acknowledgement from CSA for ordered training or training services between the buyer and CSA ACTC. „In writing“ in the following text means a signed paper document, a fax or an electronic mail.

Location

The training or training services will take place in the CSA Training Centre at the Airport Prague-Ruzyne, Czech Republic, unless otherwise mutually agreed.

Scheduling

Request for scheduling of training or simulator periods shall be made by the buyer in writing and on a first-come first-serve basis confirmed back by CSA ACTC in writing.

Cancellation Fees

Cancellation of the ordered training or simulator periods by the buyer shall be made in writing to CSA ACTC which reserves the right to charge the cancellation fees as follows :

25% of the training fee if cancelled 30 calendar days or less but not less than 16 days prior to the date of training

50% of the training fee if cancelled 15 calendar days or less but not less than 8 days prior to the date of training

75% of the training fee if cancelled 7 calendar days or less but not less than 4 days prior to the date of training

100% of the training fee if cancelled 3 calendar days prior to the date of training.

Technical Failure of the Training Equipment

In case the buyer is unable to use the training equipment, such as flight simulator, cabin mock ups, etc., due to a technical failure, the buyer will be compensated with the same amount of time as has been lost in a mutually agreed additional period of time.

Level of Training

In case the CSA examiner/instructor who carries out the training finds out or decides that the professional skills and abilities of the trainee do not reach the requested level, the buyer will be recommended further steps to be taken according to CSA's usual procedures.

Costs

Buyer shall be responsible for all costs related to training or buyer's use of CSA's training equipment, including-but not limited to :

- all transportation of buyer's personnel and all their living and incidental expenses
- any licence, certification, validation, approval, permit or other document and its availability, required by the CAA, having jurisdiction of the buyer
- any costs involved for the visa.

Price and Payment

CSA will submit invoices to the buyer for the amounts for ordered training or training services and payment shall be made in full in the appropriate currency under mutually agreed payment conditions.

A failure to pay may result in CSA's suspension or withdrawal of the provision of services, including withholding of documentation or certification. In case of suspension of a trainee from the training or his absence for whatever reason or in case of a premature finish of the training from the part of a buyer, the already covered amount will not be returned.

There has to be added 20% VAT to all net prices for training or training services according to the tax law of the Czech Republic.

Liability for Damage

CSA ACTC takes no responsibility for any loss of property, expenses arising from an injury or death of any participant unless caused by CSA's gross negligence or wilful misconduct.

CSA will not cover any costs or expenses arising from an accident or sickness of any of the buyer's personnel whenever or for whatever reason such costs or expenses have arisen. Buyer shall cover all the costs arisen from the damages of the devices caused by negligence or improper operation of its personnel.

The training equipment provided by CSA ACTC shall be in operating condition. The buyer shall promptly advise the technical staff of CSA ACTC of any technical default, breakdown or malfunction in the operation of the training equipment.

Excusable Delay

The parties shall not be responsible for delays in the performance of any training or training services due to the acts of God, fire, explosion, war, riots, strikes, governmental regulations or any other causes beyond the parties' reasonable control and not due to their fault and negligence.

Arbitration

Any dispute between the parties in connection with the General Terms and Conditions or any other agreement – if not settled between them – shall be settled by the arbitration in Prague, Czech Republic in accordance with the Czech arbitration law.

Administrative Conditions

The buyer shall ensure that any of its trainees attending the training services shall comply with the Czech regulations. In order to receive the entry permission into the airport area, the buyer shall send namely list of all trainees, their dates of birth and passport numbers at least one week prior to the training start. Upon arrival each trainee will receive a badge to be worn within the CSA ACTC premises.

Accommodation options at Prague destination



Marriott Airport Hotel ****

94 EUR per single room (including breakfast and transport between training centre and hotel)

<http://www.marriott.com/prgpa>



Ramada Airport Hotel ****

47 EUR per single room (including breakfast, with walking distance from CSA training centre – 10min.)

<http://www.hotel-ramada-airport.info/en>



Dolce Villa Hotel***

49 EUR per single room (including breakfast and transport between training centre and hotel)

<http://www.dolcevilla.cz/en>



GOLF Hotel***

41 EUR per single room (including breakfast and transport between training centre and hotel)

<http://www.hotel-golf.cz>

For bookings kindly contact **CSA Air Crew Training Centre** staff on jan.hejny@csa.cz, Prices are including 10% of VAT.

Contacts and map

Air Crew Training Department

Czech Airlines
Ruzyne Airport
160 08 Prague 6
Czech Republic
Phone: + 420 220 112 213
Fax : + 420 220 112 671
e-mail: box.crewtrain@csa.cz
Web: <http://crewtrain.czechairlines.com>

Capt. Milos Kvapil

Head of Training
Phone: + 420 220 111 167
Fax : + 420 220 112 671
e-mail: milos.kvapil@csa.cz

Drahomir Krenek

Administration Manager
Phone: + 420 220 112 510
Fax : + 420 220 112 671
e-mail: drahomir.krenek@csa.cz

Jan Hejny

Sales manager
Phone: + 420 220 111 409
Fax : + 420 220 112 671
e-mail: jan.hejny@csa.cz

Milan Hübner

Flight Simulator Manager
Phone: + 420 220 112 582
Fax : + 420 220 112 671
e-mail: milan.hubner@csa.cz

